

In vitro shaker Wave-PR/SI/SI slim

Compact sized easy to use for bench tops and inside refrigerators. The mild shaking as if shaken by hand. Optimum for Immuno Precipitation and Western Blotting at the low-temperature room.

CO₂ Incubators that can be inside this unit --> P.138-140



Each above not a mounted with the shaking platform.
(Stick sheet comes with each model. Optional accessories unavailable in SI slim.)

Features

- Mild shaking (Wave-shaped shaking)[PR]
- Seesaw shaking [SI/SI slim]
- Enable to use even inside refrigerators with 4°C [All models]

Applications

- Mild shaking of Centrifuge tubes and Large-size trays[PR]
- Mild shaking of Petri dish and Plastic containers etc. [SI/SI slim]
- Staining/Decolorization, ImmunoPrecipitation, Western Blotting, Trypsin etc.

Model	Wave-PR	Wave-SI	Wave-SI slim
Shaking motion	Wave-shaped shaking	Seesaw shaking	
Speed/Angle range (*1)	5 to 50r/min, 2 to 6°	5 to 50r/min, 2 to 10°	10 to 60r/min, 6° (fixed)
Platform dimensions	300 x 200mm		180 x 120mm
Ambient temp. range	0°C to 50°C		
Maximum load	Approx. 2kg (SI slim: Approx. 1kg *Optional platform and vessel holders not included)		
Shaking speed display	Digitally (Option)		-
Safety devices/functions	Motor protection circuit at overload, Fuse		
Dimensions (W x D x H)	300 x 235 x 163mm, Approx. 5.1kg	300 x 235 x 167mm, Approx. 5.5kg	180 x 130 x 110mm, Approx. 1.8kg
Power supply	AC100 to 240V/0.5A		
Standard accessories	1 x Stich sheet (ST-2030 for SI/PR, Dedicated type for SI slim) (*2)		-

(*1) The maximum value might not be meet depending optional platforms and vessels. (*2) Shaking platforms and vessel holders are also available as an option except SI slim.

Dimensions Wave-PR

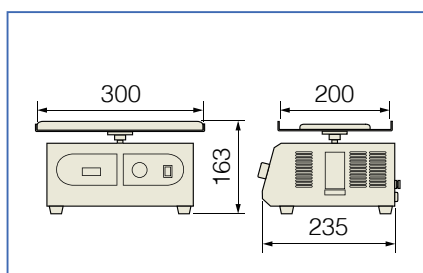

Dimensions Wave-SI

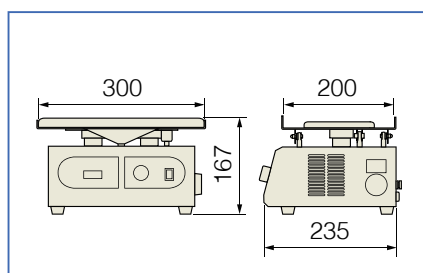

Dimensions Wave-SI slim

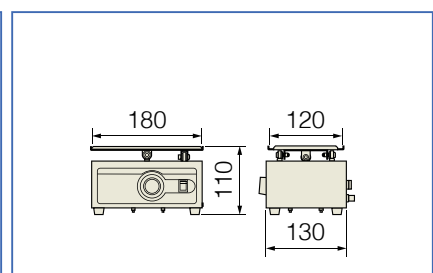

Features for Wave-PR (Wave-shaped shaking) and Wave-SI (Seesaw shaking)

Wave-PR

Wave-PR (Wave-shaped shaking) has less variation in the motion that enables the quite mild stirring constantly. Please note that when [if] a liquid volume quite less to the capacity of container/tray the liquid might not be moved to the center of tray.

[Liquid volume quite less]



[Moderate liquid volume]

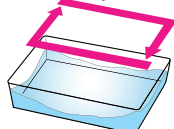

Wave-SI

By making the longitudinal of the tray inclined and reducing the liquid volume the momentum and distance of liquid can be gained. Also even liquid volume is little that can be spreaded all over the container/tray. Please note that when [if] shaking thin samples such as PAGE the gel might be rounded at the end of the plates depending any tilt angle.

[Liquid volume little or Deep angle]

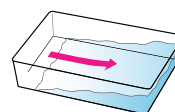

[Liquid volume large or Shallow angle]

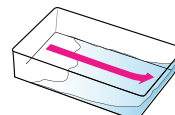

Selection guide
Constant temperature incubator shaker
CO₂ incubator shaker
Shaker
Mixer
Rotator
Stirrer
Bead beater
homogenizer
Ultrasonic homogenizer
Aluminum block bath
Minimize bath
Water bath
Shaking water bath
Immersion cooler
Hydridation oven
Constant temperature chamber
Centrifugal concentrator
Cold trap
Freeze dryer
Electrophoresis and blotting apparatus
Constant temperature water circulating system [Chiller]
Appendix

Example of Optional shaking platform in combination

Wave-PR (with Speed display)		Wave-SI (with Speed display)			
Disposable Centrifuge tubes for 50 mL	Large-size culture tray	Disposable Centrifuge tubes for 15 mL, Seesaw	100mL Color comparison tubes, Seesaw	Plastic containers or Dishes, Seesaw	Dishes or Trays, Seesaw
Centrifuge tube holder PR-3504	Large-size shaking platform WR-3636	Centrifuge tube holder PR-1808	Universal shaking platform MT-2030	Large-size shaking platform WR-3636	Two-tier shaking platform WR-2030
-	-	-	Horizontal clamp for Centrifuge tubes AT-0004	-	-

● Example of optional platform combination are selected optimally while Some combinations other than these described (e.g. Wave-PR with MR-2030 etc.) are available. Ask us for the combinations other than these as necessary.

Stick sheet (PR/SI) ◀.....▶ Centrifuge tube holder for ST-2030 (additional option)

A white-colored non-slip sheet that used placing on the platform. Eco-friendly special silicon material adopted. Adhesion weakened with dust and dirt can be recovered by washing with water.

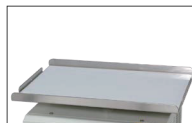

Holder that Disposable centrifuge tubes etc., placed on stick sheets for use. Can be placed one. Recommended to place in the direction of photo.

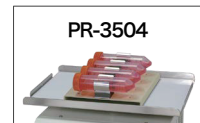

Model	ST-2030
Applicable models	Comes in Wave-PR/SI
Dimension	195x295x2Hmm

Model	PR-1808	PR-3504
Applicable models	Suitable for Wave-SI	Wave-PR/SI
Vessels / Capacity	8pcs x Vessels with $\phi 16.5$ to 20mm and approx. 150mm in length (15mL Disposal centrifuge tubes)	4pcs x Vessels with $\phi 29$ to 35mm and approx. 150mm in length (50mL Disposal centrifuge tubes)

● Used any speed and angle the vessels not fallen.

Horizontal clamp for Centrifuge tube (PR/SI) ◀.....▶ Universal shaking platform (PR/SI)

This makes Centrifuge tube, Stopped test tube or Water-compliant 100 mL Color comparison tube securely fixed. Optimal for Extraction experiment. Mounted on MT-2030 for use.

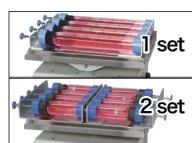

This is required when using Horizontal clamps for Centrifuge tubes on the left. Be sure use the clamps so that the vessels can be fixed.



Model	AT-0004
Vessels	Diameter 10 to 37 mm, 4pcs in 1 set
Capacity	When 1 set: Vessels with 75 to 240 mm in length such as 100 mL Color comparison tube. (*) When 2 sets: Vessels with 75 to 110 mm in length such as 50 mL Centrifuge tube.

(*)The vessels longer than 110 mm recommended for use in Wave-SI.

Model	MT-2030
Applicable models	Wave-PR/SI
Dimension	200x300x23Hmm

Large-sized shaking platform (PR/SI)

Large sized culture trays and TC flasks can be mounted. Comes with 1pc Dedicated stick sheet. Remove the standard platform to replace it.

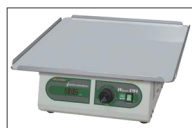

Two-tier shaking platform (SI)

Convenient to stain Mini Gel Comes with 1pc of Stick sheet ST-2030.



Model	WR-3636
Dimension	364x364x12Hmm

● Used any speed and angle the vessels not fallen.
● Comes with Stick sheet.

Model	WR-2030
Applicable models	Suitable for Wave-SI
Dimension	204x304x168Hmm

● Use any speed and angle the vessels not fallen. ● Maximum load should be 1.2kg when using this.
● Comes with Stick sheet x1.

The angles of platform for Wave-PR and Wave-SI.

USER'S VOICE

I can handle to adjust the tilt angle according to the liquid volume and sample based on the advantages and disadvantages of the wave shaking and the seesaw shaking on the left page.



Wave-PR

Indicator and Adjuster for the tilt angle are located on the right. 2°C to 6°C can be tilted to the horizontal.



Wave-SI

Adjuster located for the tilt angle on the right and Indicator located on the back. 2°C to 10°C It can be tilted to the horizontal.

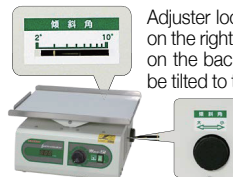

Mini-size type (PR-12 and Wave-SI slim)

USER'S VOICE

Mini-size type optimum for using confined areas such as inside Clean bench!



PR-12

"Mild Mixer PR-12" (Page 60) available as mini size of Wave-PR. It can be used with the above-mentioned centrifuge tubes holder and adjusted for the tilt angle.



Wave-SI slim

The body size about half for Wave-SI in and the platform size is the same for 1pc of Well plate. The tilt angle fixed.



● Protuberances not included in Dimensions. ● Vessels of photo not included.

Selection guide

Constant temperature incubator shaker
OD-Monitor

CO₂ incubator shaker

Shaker

Mixer
Rotator
Stirrer

Bead beater
homogenizer
Ultrasonic homogenizer

Aluminum block bath
Minimize bath

Water bath
Shaking water bath
Immersion cooler

Hybridization oven
Constant temperature chamber

Centrifugal concentrator
Cold trap

Freeze dryer

Electrophoresis and Blotting apparatus

Constant temperature water circulating system [Chiller]

Appendix